

# SOUNDPROOF AIRTIGHT DOOR

**BOTH AIRTIGHT AND SOUNDPROOFED FOR OPERATING THEATRES AND STERILE AREAS**

HOSPITALS/LABORATORIES



**SLIDING DOOR**

**SP450 STILLROOM®**

## SPECIALY CONSTRUCTED FOR MORE EFFECTIVE SOUNDPROOFING

- The **SP450 STILLROOM®** soundproof airtight door is a hermetically sealed door whose main function is to **control the risks of bacteriological or particulate contamination**.
- In addition, thanks to its special design and composition, the **SP450 STILLROOM®** door has the advantage of also providing enhanced acoustic insulation (up to 40dB) for **greater comfort in sensitive environments**.
- It is **intended for controlled environments** such as surgical suites in medical environments, sterile areas, disinfection rooms and other controlled environment premises.
- The performances of the **SP450 STILLROOM®** door have been **tested and certified by several test laboratories**, which have issued airtightness and acoustic insulation certificates.

## ENHANCED SOUND ATTENUATION UP TO -40dB

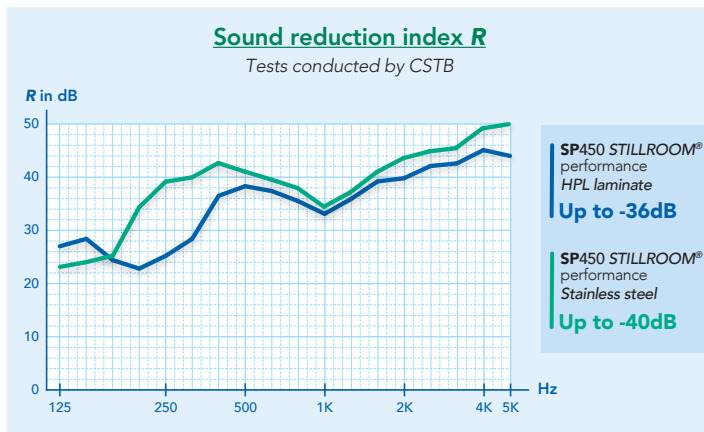

FREQUENCY IN HZ	R IN DB HPL LAMINATE	R IN DB STAINLESS STEEL
100	27.0	23.2
125	28.4	24.1
160	24.4	25.3
200	22.8	34.4
250	25.2	39.2
315	28.4	40.0
400	36.5	42.7
500	38.3	41.1
630	37.4	39.6
800	35.5	38.0
1,000	33.1	34.5
1,250	35.9	37.2
1,600	39.2	41.0
2,000	39.8	43.6
2,500	42.1	44.9
3,150	42.6	45.5
4,000	45.1	49.2
5,000	44.0	50.0

## FEATURES & BENEFITS



Very high airtightness performance



Enhanced acoustic insulation, up to -40dB



Optimum decontamination and hygiene: porthole flush on both sides, smooth, rounded shapes



Materials unaffected by cleaning products.



Test certificates approved by certified laboratories



Large choice of laminate finishes

## TECHNICAL CHARACTERISTICS

### DOOR FRAME

- Grade 304L or 316L stainless steel door frame (casings and inner casings),
- Acoustic insulation of the door frame,
- Door frames with no visible fastening screws for optimum hygiene and cleaning.

### DOOR LEAF

- Door panel made of **high pressure laminate (HPL) with an antibacterial surface**, protected and reinforced by a brushed stainless steel frame,
- Or door leaf with **brushed grade 304L or 316L stainless steel facing**,
- Acoustic insulation of the door leaf,
- Replaceable silicone perimeter seals.

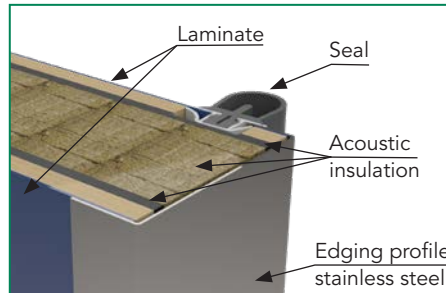

LEAF, HORIZONTAL SECTION

### TRACK

- Anodised aluminium track with polyamide runners and floor guides.



ANODISED ALUMINIUM TRACK

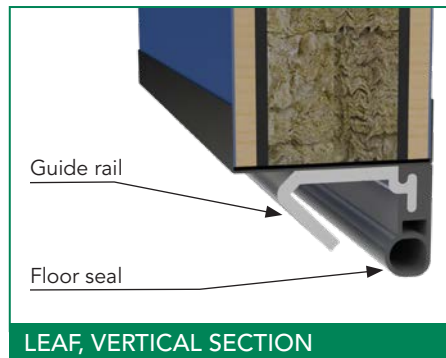

LEAF, VERTICAL SECTION

### PELMET

- Protective cover made of either anodised or coated aluminium, or coated or grade 304L or 316L stainless steel,
- Pivoting, sloped pelmet for easier cleaning.

## TECHNICAL PERFORMANCES – 1 LEAF

### ACOUSTIC INSULATION

Laminate version:  $R_w(C;Ctr) = 36 (-1; -4)$  dB | Stainless steel version:  $R_w(C;Ctr) = 40 (-2; -4)$  dB

For comparison, standard **SP450** was tested at  $R_w(C; Ctr) = 29 (-1; -2)$  dB  
Only the single-leaf door has undergone acoustic insulation testing

### AIRTIGHTNESS PERFORMANCE

Leakage rate  $< 0.02$  m<sup>3</sup>/m<sup>2</sup>/h at 20 Pa and  $< 0.04$  m<sup>3</sup>/m<sup>2</sup>/h at 50 Pa

## OPTIONS

- Porthole/vision panel flush on both sides, with SILENCE-type laminated glass,
- Large choice of colours and laminate finishes,
- Stainless steel pull handles,
- Stainless steel flush pull handle,
- Stainless steel release handle for heavy manual airtight doors,
- Acrovyn® or brushed stainless steel kick plates,
- Automatic kit,
- Specific door frames or pelmets to meet your needs, for renovation jobs in particular.



## SLIDING DOOR

### SP450 STILLROOM®

